

# Contact M16 / M23 Signal crimp pin 1 mm

Item number 7010901031

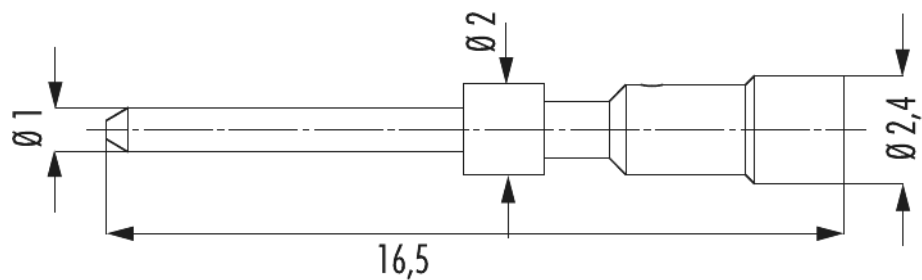

## Technical data

<b>Characteristic of connection</b>	Crimp
<b>Insert</b>	Pin
<b>Crimp contact</b>	Crimp pin signal 1 mm machined
<b>Material contact</b>	Copper-zinc alloy
<b>Material contact surface</b>	nickel, gold plated (0.25 $\mu\text{m}$ )
<b>Contact-<math>\varnothing</math> signal</b>	1 mm
<b>Length (L)</b>	16.5 mm
<b>Crimp range</b>	0.05 - 0.56 mm <sup>2</sup>
<b>Suitable crimping tool</b>	7000900904



Dimensions and specifications may be changed without prior notice